

Original User Manual – FableKids

# FableB Kids

love inspired.



Children's scooter with LED light wheels

REX/LIONEL/LILY/NOVA



CE

Thank you for your trust in **Fable KIDS**

Read the instructions carefully before use and keep them for future reference.



Dear parents,

Thank you for choosing our product. Please read the user manual carefully before using the product for the first time. If you give the product to a third party, these instructions must also be provided. Keep the instruction manual for future reference. The drawings in this manual may not correspond to the actual objects. Please refer to the physical objects.





## Table of Contents

<a href="#"><u>1. parts list</u></a>	1
<a href="#"><u>2. Specifications</u></a>	2
<a href="#"><u>3. Safety instructions</u></a>	3
<a href="#"><u>4. Security Icons</u></a>	4
<a href="#"><u>5. Assembly and use</u></a>	5
<a href="#"><u>6. Cleaning, maintenance and storage</u></a>	7
<a href="#"><u>8. Environmentally friendly disposal</u></a>	8

## 1. parts list

Part.	Name of parts
1	Handle
2	Handlebar
3	Quick Release Lever
4	Steering column
5	Folding Mechanism
6	Deck
7	Rear wheel
8	Front wheel



## 2. Technical data

Designation	Specification
Max. load capacity	50 kg
Dimensions unfolded	58*28.5*67.5cm
Dimensions folded	58*28*19cm
Handle Height Adjustable	67.5 – 78 cm
Weight	3 kg
Front Wheel Diameter	120 mm
Rear Wheel Diameter	90 mm
Ball bearing	ABEC 5
Scope of delivery	1 x scooter 1 x Allen Wrench 1 x User Manual

### 3.Safety Instructions

#### Warnings

**Important: Please read these instructions carefully before use and keep them for future reference. Your child's safety may be at risk if these instructions are not followed. Failure to follow these warnings and instructions can result in serious injury or death.**

- The scooter is designed as a toy and is recommended for children aged 3 and over.
- The maximum load capacity of the scooter is 50 kg.
- The scooter is not intended for use on public roads or sidewalks and may only be used in private areas under adult supervision.
- The scooter is not suitable for jumps, stunts or stunts.
- The scooter is intended for private use only and is not suitable for commercial use.
- Children can get caught in packaging materials while playing and suffocate. Remove the packaging material before handing the scooter over to children to play with, and keep the packaging material away from children
- Attention. For use with protective equipment. Do not use in road traffic. max. 50 kg
- The preparation of the scooter for the ride must be carried out by an adult
- 
- Do not let children ride the scooter unsupervised. Warn children of potential dangers before use.
- Make sure that children only use the scooter on flat, clean and dry surfaces. Make sure that the scooter is not used near stairs, chasms or bodies of water. The scooter should only be used in good visibility conditions and not at dusk or in the dark.
- Make sure that children always have both hands on the handlebars. The handlebars must be free of objects, such as bags hanging from them.
- Make sure that children only use the scooter with sturdy shoes and suitable protective equipment. This includes a safety helmet as well as wrist, knee and elbow protectors.
- The scooter can only be used by one child at a time.
- The scooter can only be used in perfect condition. Check the scooter for damage and wear and tear before each use.
- In particular, check that all fasteners are tight.
- In particular, make sure that the metal pins on the steering column and handlebars snap into place.
- Do not make any modifications or repairs to the scooter or the warranty will be voided.
- Warning! Assembly by an adult
- Warning! Protective equipment should be worn. Not to be used in traffic. 50kg max.
- The toy shall be used with caution, since skills is required to avoid falls or collisions causing injury tot he user or third parties.
- There are dangers of using the toy scooters on public highways such as car accident, crash etc.

## 4. Safety symbols



Follow the instructions before use!



Wear protective clothing when using it!



This symbol/word refers to a medium-risk hazard that, if not avoided, can result in death or serious injury.



The maximum load capacity of the scooter is 50 kg



Recommended for children aged 3 and over.



Declaration of Conformity: Articles marked with this mark meet the requirements of the EC Directives.

## 5. Assembly and use

### Unfolding the scooter

Pull the folding mechanism (5) up and hold it in this position. Make sure the lock is fully engaged to secure the mechanism.

Gently pull the bracket (4) up while holding the lock (5) engaged. Continue until the scooter is fully unfolded.

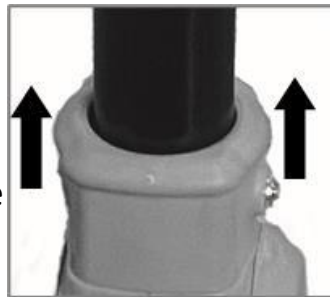

NOTE: Make sure the snap lock remains in place until the steering column is fully extended and securely seated. Before use, check that all parts are stable and safe.

### Height

The scooter can be adjusted in 3 different heights. Make sure that the product is only used when the locking knob is firmly engaged in one of the 3 holes provided for this purpose and the steering column is secured with the quick release buckle.

- Open the quick-release lever (3)
- Lenksäule (4)
- Pull the handlebar (2) up until the locking button clicks into one of the three holes.
- Lock the steering column by closing the quick-release lever.

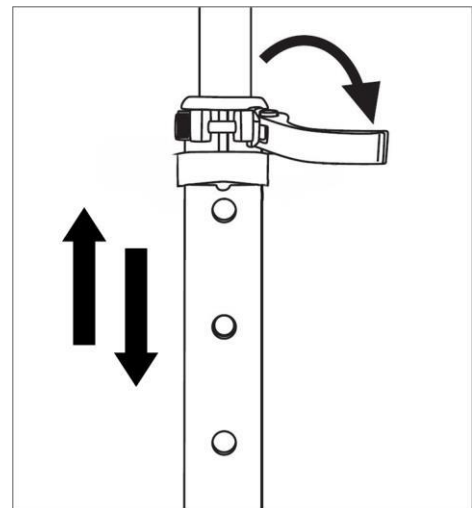



## How to Use the Scooter

### Drive:

- Hold the handlebars firmly with both hands.
- Place one foot firmly on the tread and push yourself with the lift the other foot off the ground to get going.
- Control the direction of the scooter by shifting your weight:
- Tilt your body to the left to steer to the left.
- Tilt your body to the right to steer to the right.

### Brake:

- Apply the rear brake (7) by moving your foot down to slow down and stop.
- Do not disassemble the scooter until it has come to a complete stop It's.

## Folding the scooter

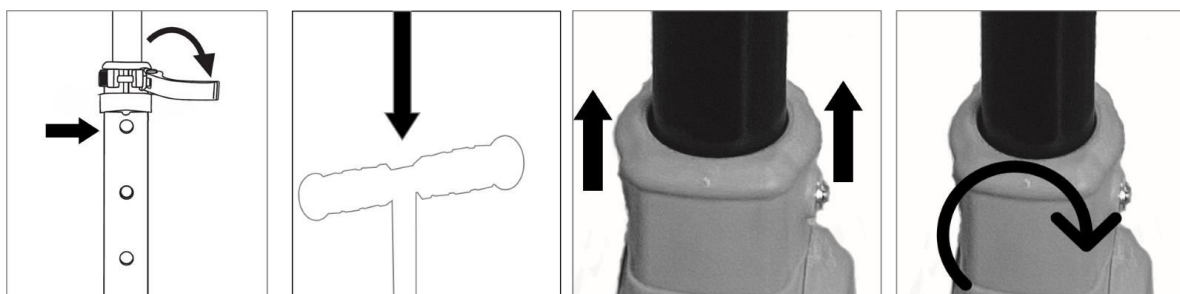

- Loosen the quick-release lever (3) on the handlebar (2) and press the Lock button.
- Press the handlebar (2) all the way down and tighten the quick-release lever (3).
- Pull the flip closure up and hold it in place.
- Gently lower the steering column until it is flat on the deck.
- NOTE: Make sure the latch remains active until the steering column fully engages on the tread.

## 6. Cleaning, maintenance and storage

- Wipe the scooter with a damp cloth. Do not use solvent-based or aggressive cleaning agents. Allow the scooter to dry completely after cleaning.
- Dry wet or damp ball bearings with a clean cloth. Grease the bearings from the outside with a suitable bearing grease to prevent rusting.
- Check the scooter for damage and wear before and after use.
- Under load, the effect of self-locking nuts and other fasteners may decrease. Check them regularly and tighten them if necessary.
- In particular, check the strength of the screws and tighten the screws if necessary. If the scooter is damaged, discontinue use. Do not make any structural repairs or modifications to the scooter.
- Storage:
- Clean the scooter before storing it and let it dry completely.
- Store the scooter in a dry, frost-free place that is inaccessible to children.

## 7. Environmentally friendly disposal

**Warning: Choking hazard!** The packaging material is dangerous for children. Never let children play with the packaging material.

7.1 Disposal and packaging The packaging of the device consists of materials that are necessary for effective protection during transport. These materials are fully recyclable and thus reduce the environmental impact. Dispose of the packaging in a container for recyclables.

7.2 Disposal of old equipment WEEE must be disposed of in accordance with the guidelines and regulations of the local waste management authorities. Contact your local authorities to get the address of the nearest recycling center and drop off the device.

The actual design of the products may differ from the pictures shown. All images in this user manual are for reference only.

The product has been tested and complies with the following standards:

EN 71- 1:2014+A1:2018

EN 71-2:2020

EN 71-3:2019+A1:2021





Company headquarters:  
Mythical children  
Gneisenaustrasse 10 - 11  
D 97074 Würzburg

Please find the return address in the imprint:  
[https:// www.fable-kids.com](https://www.fable-kids.com)

Sales tax identification number: DE 263752326  
The registration court in the commercial register is Würzburg, HRB 10082  
WEEE Reg.-No. DE 16117071



Headquarters: FableKids • Gneisenaustraße 10-11 • 97074  
Würzburg



Contact Customer Service:  
Phone +49 (0) 931 90 80 3000



E-Mail: [info@fable-kids.com](mailto:info@fable-kids.com)

